

**ADDENDUM NO. 3
TO THE BID DOCUMENTS
FOR THE
ATCT RENOVATIONS PHASE II- GLASS REPLACEMENT
BOCA RATON AIRPORT
BOCA RATON, FLORIDA**

Project funded by:

FLORIDA DEPARTMENT OF TRANSPORTATION (FDOT)

October 31, 2018

PAGE 1 of 1

TO: ALL HOLDERS OF CONTRACT DOCUMENTS

- a. Your attention is directed to the following interpretations of, changes in, and additions to the Contract Specifications and Plans for the above named project at Boca Raton Airport, Boca Raton, Florida.
- b. This Addendum is part of the Contract Documents and Plans, and the bidders are required to acknowledge receipt of this Addendum in the space provided below.

This addendum includes the following (see attachments):

- 2. **CONTRACTOR QUESTIONS** - (attached)

NOTE: Sign and Return Addendum #3 Cover with Bids

Acknowledged: _____ signature of Bidder

Name of Bidder: _____ Date: _____

END OF ADDENDUM NO. 3

**ADDENDUM NO. 3
TO THE BID DOCUMENTS
ATCT RENOVATIONS PHASE II- GLASS REPLACEMENT
BOCA RATON AIRPORT
BOCA RATON, FLORIDA**

October 31, 2018

PAGE 1 of 3

Addendum #3 – Bidder's Questions

Q: My understanding is to remove and replace one of six sides of the cab per night.

A: That is correct.

Q: In addition to the removal of the motorized hurricane shades, is the remaining removal just the aluminum frame and glass?

A: Contractor to remove **JUST** the aluminum frame and glass and the hurricane shutters. As shown in these notes and demo plan.

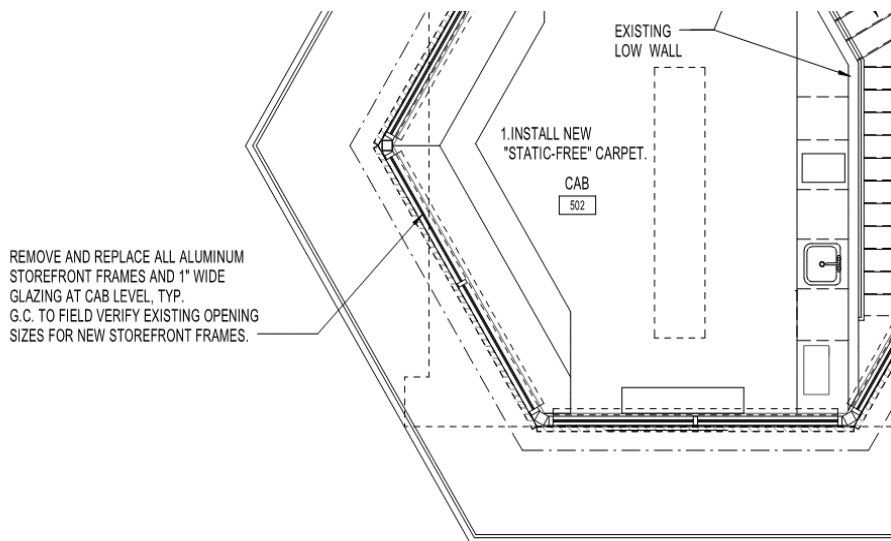

 REMOVE EXISTING MOTORIZED HURRICANE SHUTTERS, TRACK & HARDWARE AND TURN OVER TO OWNER.
* REPAIR/ REPLACE EXTERIOR WALL PANEL SURFACES BEHIND HURRICANE SHUTTERS HOUSING TO MATCH ADJACENT. DISCONNECT ELECTRICAL ASSOCIATED, SEE ELECTRICAL.

**ADDENDUM NO. 3
TO THE BID DOCUMENTS
ATCT RENOVATIONS PHASE II- GLASS REPLACEMENT
BOCA RATON AIRPORT
BOCA RATON, FLORIDA**

PAGE 2 of 3

Q: Since a new pocket will force the repositioning of the shade mounting, the shades currently in place will need to be cut down in the field to fit, if they wouldn't be too small to begin with. The labor cost for the adapting of 12 shades would be more than a new set. The shades currently in place are now 7 years old. The service period for these shades are 5 - 8 years. It's not worth fitting a set that old.

A: The shade pocket may not be a requirement. A second set of shades may be mounted above the existing in the space between the existing roller and the ceiling?

Q: We would recommend that full width shades be used to avoid a center gap light leak between 2 shades. However, the span noted on page A651.1 shows a width of more than 13'. Understanding that the pocket will be slightly smaller (but unsure exactly), the widest our shade tubes can go is 12'. If the bisecting points of the pocket are 12'- 4" or less, by utilizing a 'down-cut' method, we can make the span. Otherwise side by side shades will be necessary with an 1 1/2" gap in between.

A: The shades are to be full width of window opening per plan and existing condition. See shade pocket requirement, above.

Remove and reinstall existing Shades per each side during glazing. When glazing is finished, remove and dispose of existing Shades. Replace with new primary and add darker secondary shades. Primary Shades shall be FAA type as approved and be installed closest to the window glass. The secondary shade shall be installed behind (toward cab center) the primary as indicated in the plans.

Q: The one supplier we have contacted will provide the Low-E, however, they will not warranty the glass to pass the "L" test. Please advise.

A: I believe the question has to do with which side of the Laminated Insulated Glass Unit (LIGU) glazing is the low e being applied to. The concern here is what happens if the low e is installed on the same surface as the SentryGlas? That is not the design intent. The low e coating shall be installed on the inside of the outer panel, that is facing the 1/2" air space. Revise Spec 08 80 10, paragraph 2.02.E to the following (change is underlined).

Outer Panel 1/4" glass / 0.060" SentryGlas / 1/4" glass
Low e Applied to the inside (air space side) surface of outer panel
Air Space 1/2" with capillary tube
Inner Panel 1/4" glass / 0.060" SentryGlas / 1/4" glass
Total Nominal Thickness 1 5/8" LIGU thickness

**ADDENDUM NO. 3
TO THE BID DOCUMENTS
ATCT RENOVATIONS PHASE II- GLASS REPLACEMENT
BOCA RATON AIRPORT
BOCA RATON, FLORIDA**

PAGE 3 of 3

Note:

Existing Transparent Shades are recommended to be removed during the night work and reinstalled by morning so they do not get damaged.

It is also imperative that the existing inside electronics remain clean and dry during all operations and construction activities. Please note specifically there is an FAA “STARS” display that is next to the front window mullion/column that needs to be protected at all times.